



**Acora Acoustics**  
**-HEAR THE TRUTH-**  
Owner's Manual  
SRB  
Bookshelf Speaker



(SRB shown with optional SRS Stands)





## Welcome

Thank you for selecting Acora Acoustics as your new loudspeaker.

The SRB has been designed to bring you closer to your music by using specialized drivers, custom hand-built crossover networks, and all granite enclosures constructed by artisans with decades of experience.

Please read through this manual to ensure you get the years of musical truth from your new SRBs that we feel you should expect.

The SRB loudspeaker, as it is in a full granite enclosure, is quite heavy and should not be placed or re-positioned by a single person, seek qualified assistance such as your Acora Acoustics dealer or consultant.

We suggest the following:

- 1) Thoroughly read through this manual
- 2) Follow the Unpack and Placement instructions
- 3) Make connections to your amplifier with its power turned off
- 4) Make sure volume is set to an appropriate level before turning amplifier power on.

Each Acora Acoustics loudspeaker has been inspected, tested, gone through initial break in, and packaged with care.



# Unpacking and Initial Placement

Each Acora Acoustics loudspeaker has been inspected and packaged with pride. Please verify that both boxes are in good condition and the serial numbers are consecutive.

Please use extra caution when unpacking the SRB alone. Have your dealer or consultant perform or at least assist with this process. The SRB is heavy and should not be moved without qualified assistance.

1) Remove the speaker from the carton by removing the 4 clips on the lower edge of the carton (see below), then lifting the top straight up.

2) With the top removed you can now pick up the SRB up by positioning your fingers under the speaker at the sides and lifting it out of the bottom tray.

(Use caution not to grasp the speaker near the drivers or the terminals as you could damage them.)

3) Visually inspect the speaker for any transit damage.

4) The SRB is designed as a stand mount speaker. Please ensure that your stands are designed to support 60+ pounds, are 25" to 30" from floor to supporting base (depending on height of listening position) and are level. Supporting base should be at least 6" x 6" square to support the SRB. A small dab of reusable adhesive putty is recommended to keep the SRB from sliding off the base and to couple the speaker to the stand.

For initial positioning, place the speakers parallel to the rear wall, roughly the same distance between them as they are to the main listening position (if you sit 12' back from them, start with the speakers 12' apart if possible unless side walls prevent it) Typically, the speakers will image best when not towed in.

6) Connect your speakers to your amplifier and perform initial listening tests. This very well may not be their final position. (See page 4)

7) After you believe you have final placement, re-check that the stands (and speakers) are level.

8) Retain shipping carton for future use.

Listen and enjoy. You may find over time that you want to re-adjust speaker placement, again, please do not attempt this alone.

1) Pinch the two vertical ribs so the bottom swings out from the base.

2) Swing the paddle up and pull entire clip out when it becomes free.

3) Save these clips for future use

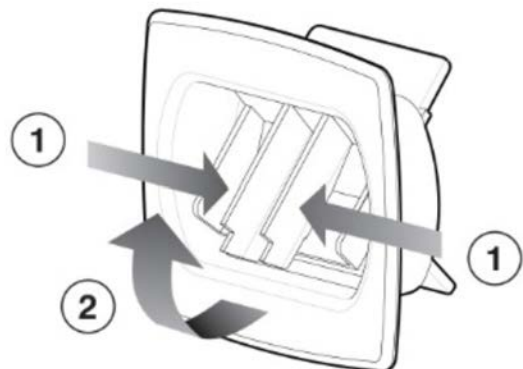



## Making Connections

Any time you are making changes to the speaker connections to your amplifier, that amplifier should be switched OFF. Please double check all connections before turning the amplifier back on. Failing to do this could result in damage to your amplifier.

The connection block on the SRB will accommodate bare wire, spade lugs, or banana terminations. As you face the back of the speaker, the terminal on your left is the - NEG connector and the right is the + POS. Typically speaker cables will also be designated by RED and BLACK. Regardless of color, you should be sure to match the same color to the "+" and "-" at both the speaker and at the amplifier. Insuring the correct polarity (or phase) will provide optimum sound quality from your system. Incorrect (out of phase) wiring would cause a loss of bass and unclear center imaging.

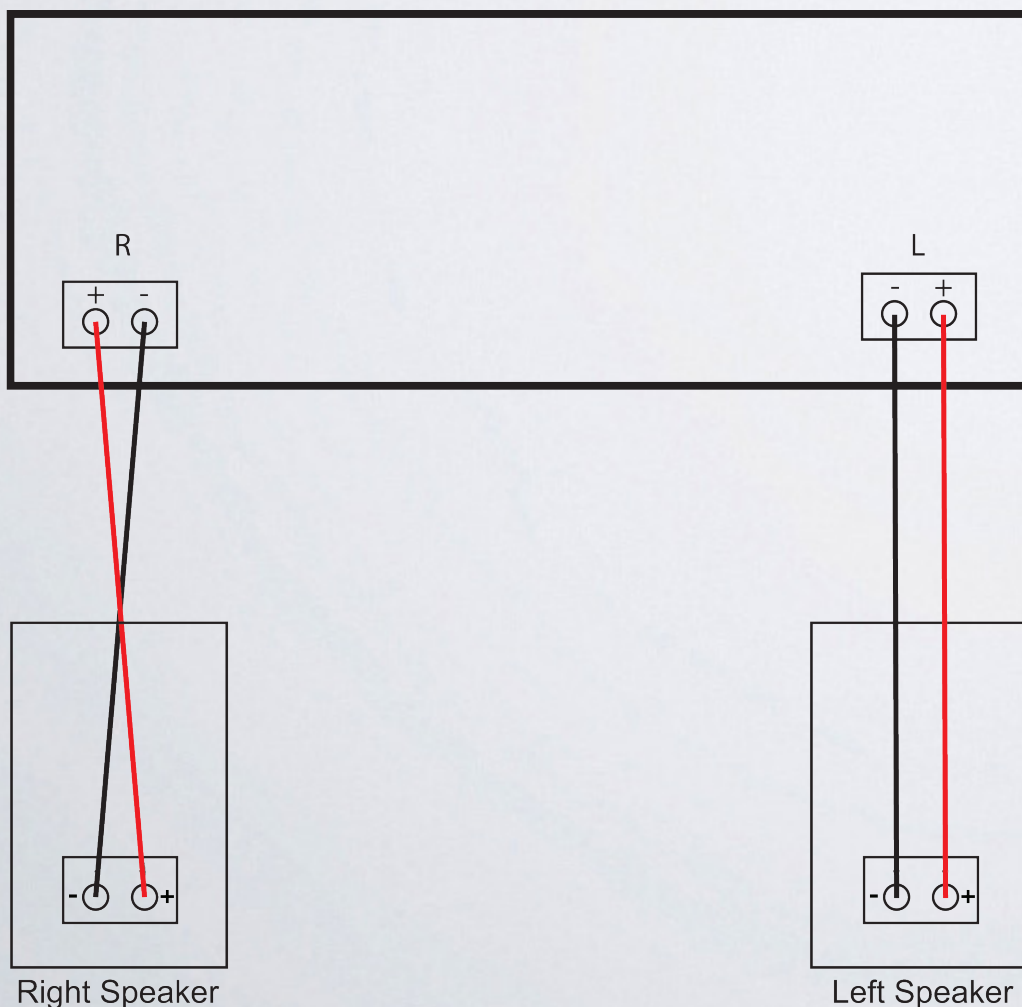



# Amplifier Requirements and Power Handling

While conditions vary widely, such as room size, preferred listening level, and content being listened to, these basic guidelines may be of value when mating the SRBs with the right amplifier for you. Remember, it is more likely to damage a speaker by using an amplifier with insufficient power required to drive the speakers to a desired volume, than it is to damage the speakers with excessive power. An amplifier being driven past its capabilities will output higher distortion when driven past its rating (clipping). This generates more heat and is typically what causes damage to a speaker.

We recommend amplifiers between 10 watts per channel, and 150 watts per channel.



# SRB Specifications

Type - 2 Way Bass Reflex

Woofer - 5.5" Sandwich Paper Cone

Tweeter - 1" Beryllium Dome Tweeter

Nominal impedance - 8 ohm

Suggested amplifier range - 10w - 150w

Sensitivity - 86.5 1w/1m

Frequency Range - 43Hz - 35KHz

Enclosure - High Polish Black Granite 2cm

Exterior dimensions - 9" x 11" x 13"

Weight - 58lbs each



(SRB shown with optional SRS Stands)



# Caring for your Acora Acoustics

The SRB granite enclosures require minimal care. We have included a small bottle of granite polish and a polishing chamois. These will restore the gloss and luster to your speakers' enclosure, however it will cause damage your speakers' drivers. Do NOT spray polish on the drivers, do NOT use a damp cloth of any kind on the drivers themselves. Damage to the drivers due to moisture or polish would affect the sound quality and would not qualify for warranty repairs. If there are any questions regarding the care of your speakers, please contact your dealer, or the Acora factory.

(DO NOT POLISH INSIDE THESE CIRCLES - AVOID ANY MOISTURE)





Please, *Enjoy!*



**Acora Acoustics**

**-HEAR THE TRUTH-**

165 Milner Ave  
Scarborough, ON, Canada  
M1S 4G7

(647) 812-3933

[info@acoraacoustics.com](mailto:info@acoraacoustics.com)